

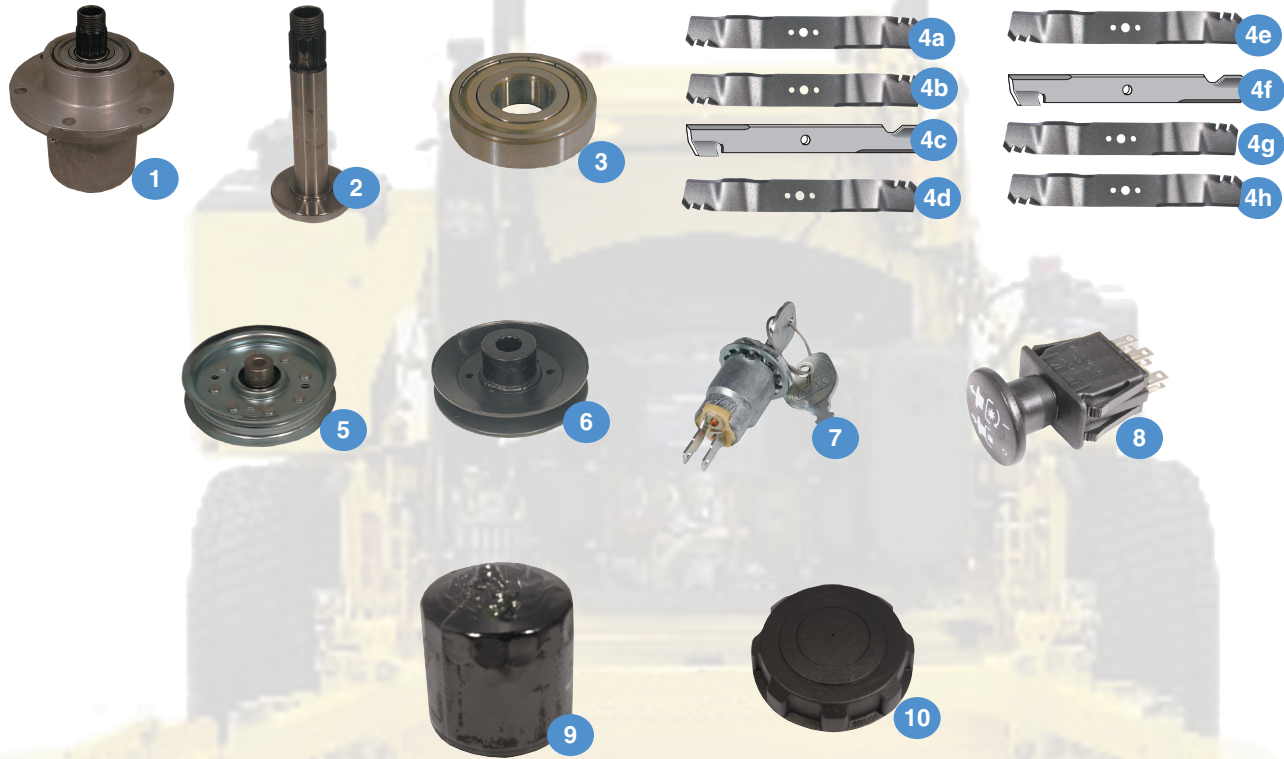

Great Dane Super Surfer



REF. NO.	DESCRIPTION	REPLACES GREAT DANE NO.	STENS NO.
1.	Spindle Assembly	200041/D18030	285-181
2.	Spindle Shaft, fits our 285-181	200043/D18048	285-350
3.	Heavy-Duty Spindle Bearing	200046/D18045	230-090
4.	a. Platinum Toothed Blade for 48" deck, 2 1/2" W x 16 1/2" L x 5/8" CH	D18086/GDU10230	303-108
	b. H-D Platinum Toohed Blade for 48" deck, 2 1/2" W x 16 1/2" L x 5/8" CH	D18086/GDU10230	303-392
	c. Blade for 52" deck, 2 1/2" W x 18" L x 5/8" CH	GDU10231/D18037	340-158
	d. Platinum Toothed Blade for 52" deck, 2 1/2" W x 18" L x 5/8" CH	GDU10231/D18037	303-116
	e. H-D Platinum Toothed Blade for 52" deck, 2 1/2" W x 18" L x 5/8" CH	GDU10231	303-336
	f. Blade for 61" deck, 2 1/2" W x 21" L x 5/8" CH	GDU10232/D18036	340-117
	g. Platinum Toothed Blade for 61" deck, 2 1/2" W x 21" L x 5/8" CH	GDU10232/D18036	303-124
	h. H-D Platinum Toothed Blade for 61" deck, 2 1/2" W x 21" L x 5/8" CH	GDU10232/D18036	303-332
5.	Heavy-Duty Flat Idler	D18314	280-572
6.	Spindle Pulley for 52" deck	D18084	275-207
7.	Starter Switch	D18090	430-029
8.	PTO Switch	D38005	430-798
9.	Transmission Filter	GDA10137/D18094	120-372
10.	Gas Cap with Vent	D18097	125-144